

# Sanitary 2 Piece Ball Valve

## 卫生级两片式（直通）球阀

### Product Information 产品信息

2 Piece Ball Valve widely used in beverage, brewing, oil refinery, cosmetic and chemical industries.

直通球阀普遍应用于饮料，酿酒，炼油，化妆品和化学工业。

- Operation: Manual, Pneumatic, Actuator  
操控：手动，气动，电动
- Working Temperature : -20°C to +135°C  
工作温度： -20°C to +135°C
- Working Pressure : 1.6Mpa (16bar)  
工作压力： 16 Bar
- Steel Material: 304 / 316L  
金属材质： 304/316L
- Seal Material : Teflon  
密封圈材质： 四氟乙烯
- Size: 1/2" to 4" (other sizes available on request)



Size	d	D	L	H	S
1/2"	10.0	25.5	75.0	41.0	95.0
3/4"	17.0	50.5	100.0	47.0	124.0
1.0"	22.0	50.5	120.0	62.0	132.0
1.5"	35.0	50.5	140.0	76.0	154.0
2.0"	47.5	64.0	164.0	91.0	173.0
2.5"	60.0	77.5	190.0	97.0	173.0
3.0"	72.0	91.0	215.0	106.0	234.0
4.0"	100.0	119.0	260.0	164.0	244.0

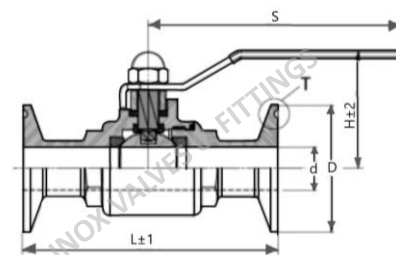

Size	d	D	L	Cylinder Model
1/2"	10.0	25.5	75.0	AT40
3/4"	17.0	50.5	100.0	AT52
1.0"	22.0	50.5	120.0	AT63
1.5"	35.0	50.5	140.0	AT75
2.0"	47.5	64.0	164.0	AT83
2.5"	60.0	77.5	190.0	AT92
3.0"	72.0	91.0	215.0	AT105
4.0"	100.0	119.0	260.0	AT125

